

INFINITY HC WALL

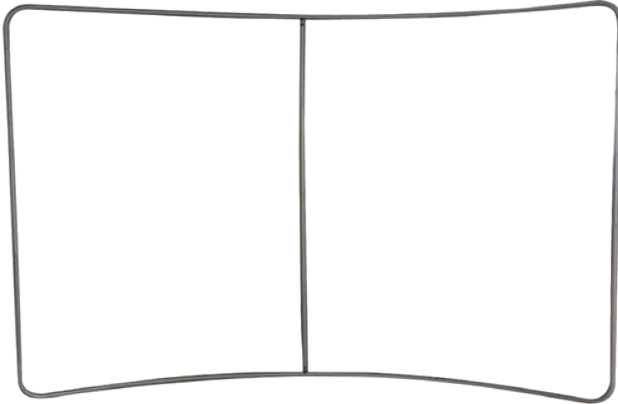

Assembled Frame



Assembled frame with graphic

- 1** Connect poles by matching shapes and numbers.

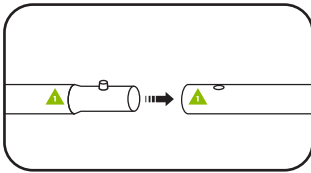

- 2** Connect and attach vertical spreaders (if included).

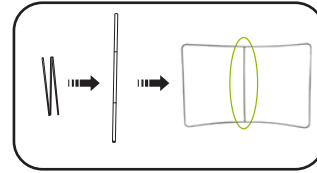

- 3** Connect stand to feet.

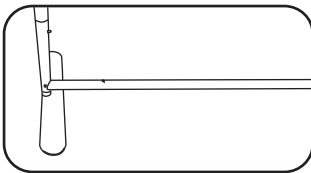

- 4** Slide graphic over frame and zip bottom closed.

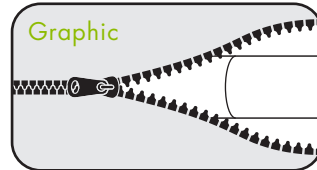
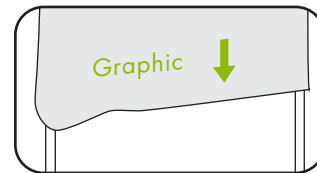

NOTE: COVER IS DESIGNED TO FIT SNUG/TIGHT TO HELP PULL OUT WRINKLES